

SAWYER SMALL HANGING SHADE

KSP1171

General Product Information

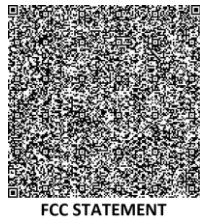
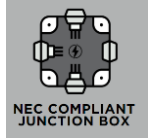
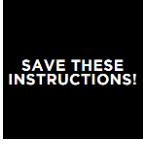

Tools Required



Safety Information

CAUTION-RISK OF FIRE

This product must be installed in accordance with the applicable installation code by a person familiar with the construction and operation of the product and the hazards involved.

USE MINIMUM 90°C SUPPLY CONDUCTORS.



Turn off electrical current at the source before working with any lighting fixture or portable lamp.

Install and use this product in adherence with local electrical codes and regulations.



+

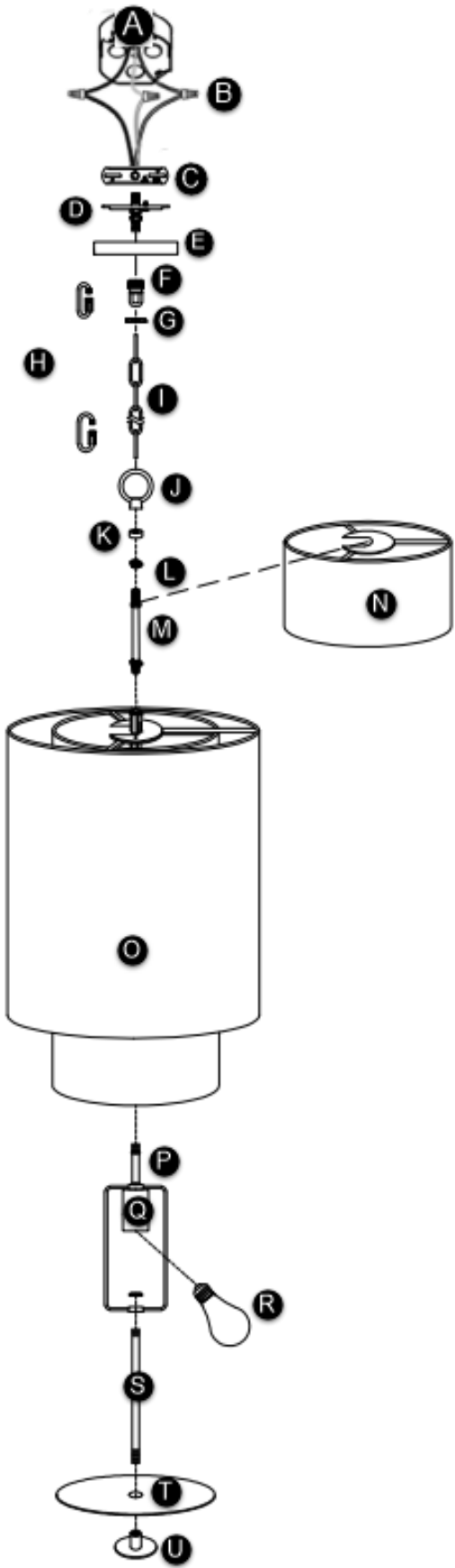

FIXTURE PARTS

- A. Junction box
- B. Wires and wire nut
- C. Mounting bar
- D. Threaded rod
- E. Canopy
- F. Canopy loop
- G. Collar Nut
- H. Quick link
- I. Chain
- J. Fixture loop
- K. Check Ring
- L. Fixture Nut
- M. Stem
- N. Small shade
- O. Large shade
- P. Threaded stem
- Q. Socket
- R. Bulb (Not Included)
- S. Bottom stem
- T. Glass disk
- U. End cap

INSTRUCTIONS

I. Preparing the Fixture

1. If necessary, screw the shorter end of the threaded rod tightly onto the mounting plate and the screw collar/canopy loop onto the threaded rod.
2. Secure the mounting plate to the junction box.
3. Feed the fixture and ground wires through the large shade and secure them over the socket cluster by screwing them together.
4. Feed the fixture and ground wires through the stem and screw them onto the large shade.
5. Feed the fixture and ground wires through the small shade, fixture nut, check ring and fixture loop, and lock them together by fastening the fixture nut and fixture loop onto the stem.
6. Determine the desired height of the fixture and adjust the chain accordingly by doing the following:
 - a) Remove a portion of the chain by opening a link with pliers.
 - b) Install the bottom end of chain onto the fixture loop using the lower quick link.
 - c) Unscrew the collar nut from the screw collar.
 - d) Install the collar nut onto the chain.
 - e) Then install the canopy onto the chain.
 - f) Install the upper quick link onto the remaining end of chain.
 - g) Secure the quick link onto the canopy loop.
7. Weave the cord through the chain, collar nut, canopy, screw collar, threaded rod, and out of the junction box.
8. Trim the cord leaving enough to make electrical connections.

II. Wiring the Fixture

1. Safety first! Locate the circuit breaker and switch it off to cut off the power supply to the relevant circuits to ensure there's no electricity running through the wiring.
2. In accordance with local electrical codes, connect the fixture ground wire (bare copper or silver wire) to suitable ground. This may be a green ground screw on the mounting plate, which the ground wire should be tightly wrapped around or a house wire (green or bare copper wire without insulation).
3. Twist the bare ends of the following pairs of wires together using a wire nut to secure a connection:
 - a) Hot fixture wire (round and smooth) and hot power line wire from the junction box (hot to hot)
 - b) Neutral fixture wire (square and rigid) and neutral power line wire from the junction box (neutral to neutral)
4. Carefully tuck all wires into the junction box.

III. Installing the Fixture

1. Place the canopy onto the ceiling and secure it in place by screwing the collar nut tightly onto the screw collar.
2. Screw the bulbs into the sockets. Please refer to the label on the socket for max wattage information.
3. Screw and secure the bottom stem into the socket assembly.
4. Place the glass disk against the glass tabs on the bottom rim of the large shade and secure it in place by screwing the end cap onto the bottom stem.